



the lincoln
HOTEL

MEETINGS AND EVENTS



The Cathedral Suite

for up to 150 people

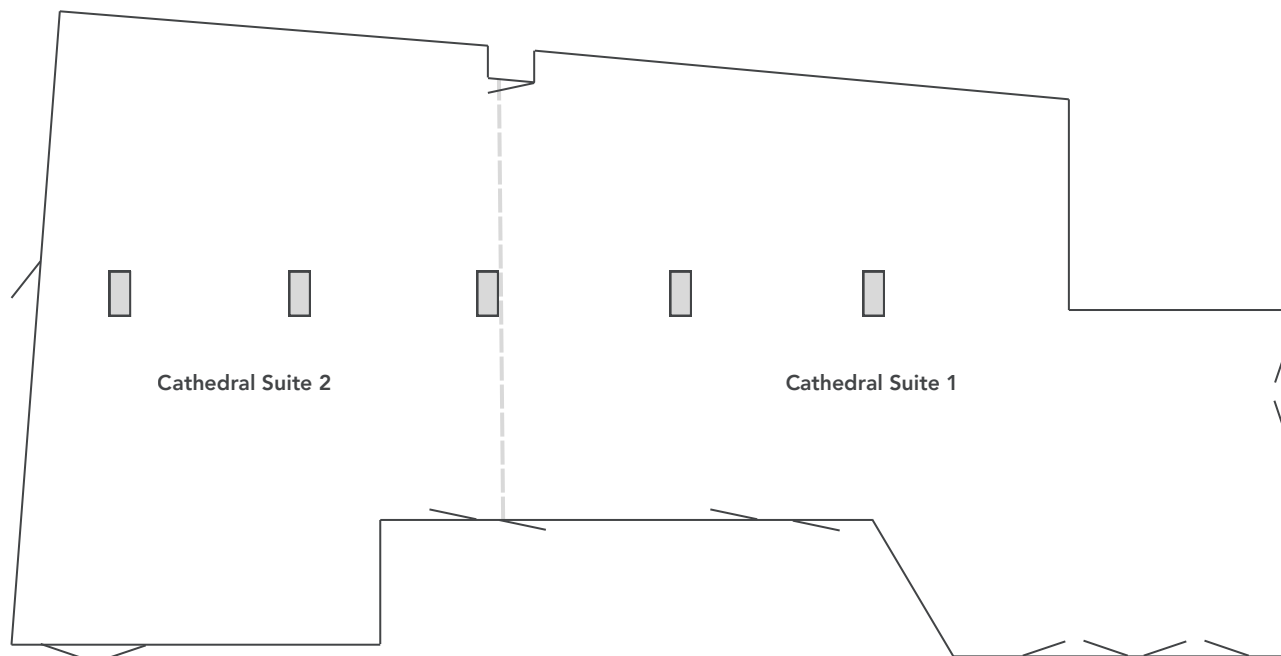

ROOM LAYOUTS

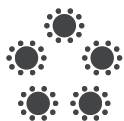

150



40

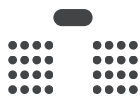

120



60



30



40

The Cathedral Suite is a spacious room that can be partitioned into two separate areas (Cathedral Suite 1 and Cathedral Suite 2), making it perfect for large events or more intimate gatherings.

The room has its own private bar and terrace area, and benefits from floor to ceiling windows with unbeatable Cathedral views.

ROOM DIMENSIONS

Cathedral Suite 1 - 14.5m x 10.5m (maximum)

Cathedral Suite 2 - 11.4m x 8.0m (maximum)

POWER SOCKETS

24

ACCESS

This room is located at ground level with main guest toilet facilities. Ground level is accessible via the lift from basement level, or alternatively with level access from our Eastbight entrance. The hotel car park is located at basement level.





The Tennyson Suite

for up to 100 people

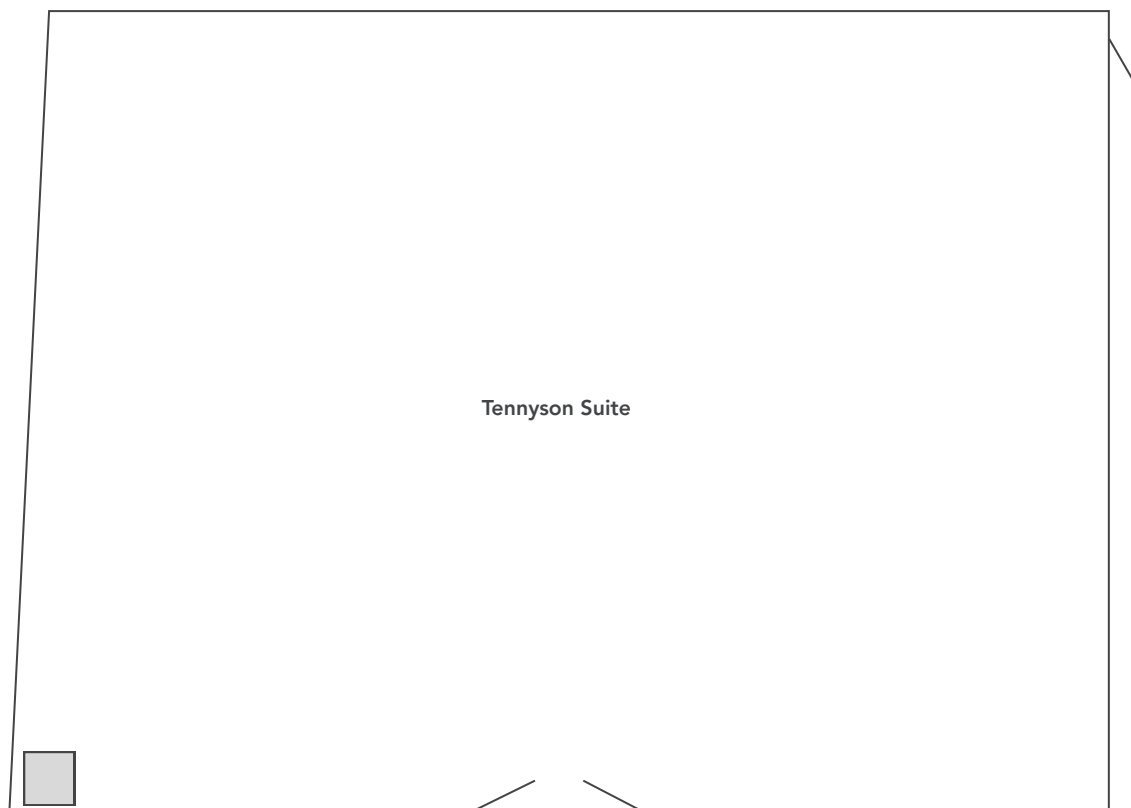

ROOM LAYOUTS

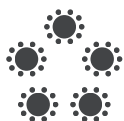

50



40

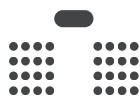

100



30



50



30

The Tennyson Suite is the perfect space for smaller events such as baby showers, meetings and intimate dinners.

Guests can purchase drinks from our Lounge Bar which is located close by the room.

ROOM DIMENSIONS

9.0m x 9.0m

POWER SOCKETS

10

ACCESS

This room is located at ground level with main guest toilet facilities. Ground level is accessible via the lift from basement level, or alternatively with level access from our Eastbight entrance. The hotel car park is located at basement level.





Bar'67

for up to 60 people

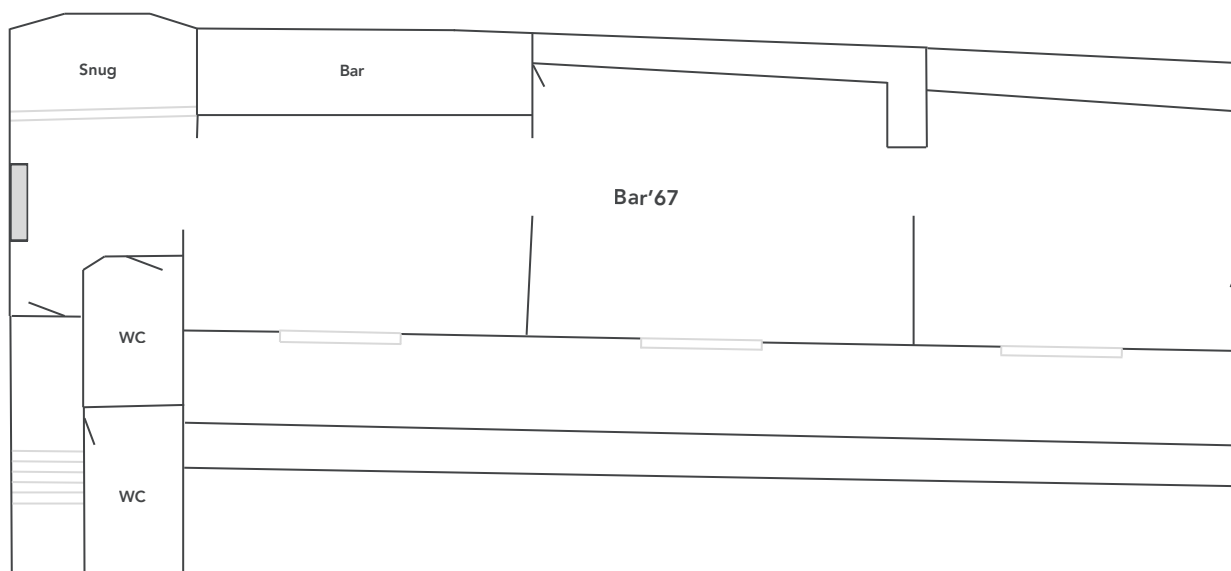

ROOM LAYOUT

This room comprises booth seating, smaller tables of two and four seats, with bar tables and stools.

Bar'67 is a relaxed cellar bar, perfect for birthday parties and celebrations.

The room has its own external entrance with a private bar and toilet facilities, providing a fully exclusive party room.

ROOM DIMENSIONS

10.7m 6.0m (maximum)

POWER SOCKETS

10

ACCESS

This room is not fully accessible for guests with mobility considerations due to being below basement level. There are four small steps down into the bar, and one step down into the booth seating.





The Eastbight Room

for up to 20 people

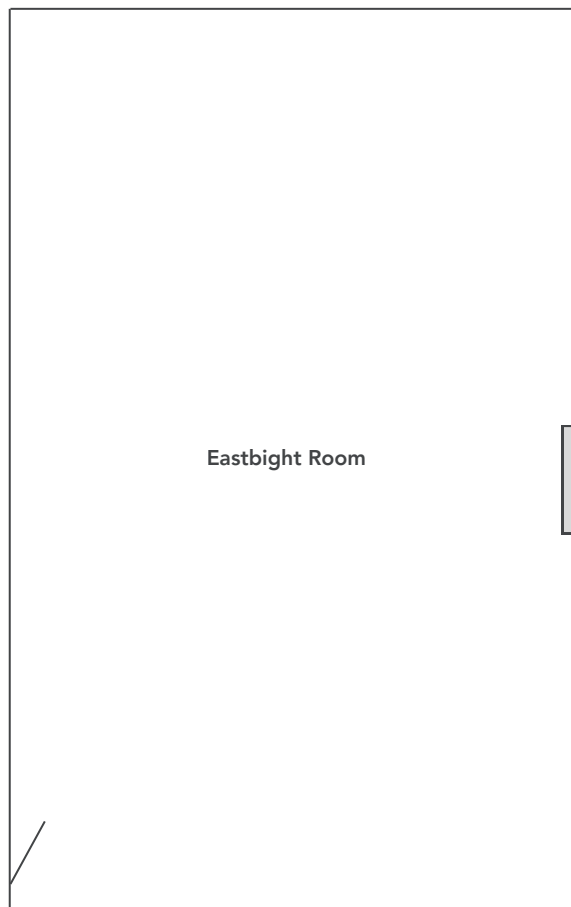

ROOM LAYOUTS

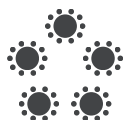

16



16

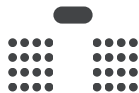

25



10



12



15

The Eastbight Room is a neutral and bright space, ideal for team meetings and small presentations.

Guests can purchase drinks from our Lounge Bar which is located close by the room.

ROOM DIMENSIONS

6.0m x 4.7m

POWER SOCKETS

8

ACCESS

This room is located at ground level with main guest toilet facilities. Ground level is accessible via the lift from basement level, or alternatively with level access from our Eastbight entrance. The hotel car park is located at basement level.





The Eastgate Room

for up to 20 people

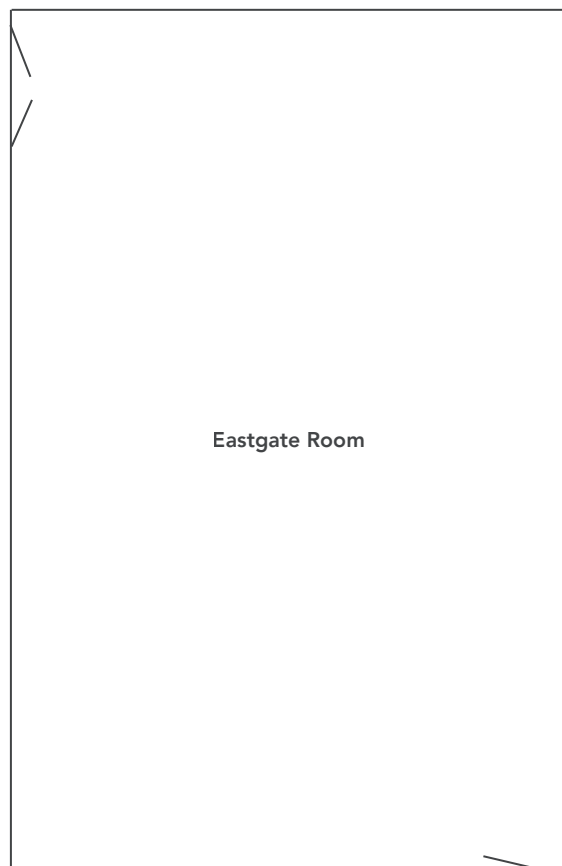

ROOM LAYOUTS

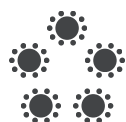

16



16

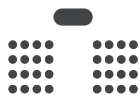

25



10



12



15

The Eastgate Room is modern and bright, with stunning views of Lincoln Cathedral. This space is great for small meetings and intimate family gatherings.

Guests can purchase drinks from our Lounge Bar which is located close by the room.

ROOM DIMENSIONS

6.0m x 4.7m

POWER SOCKETS

4

ACCESS

This room is located at ground level with main guest toilet facilities. Ground level is accessible via the lift from basement level, or alternatively with level access from our Eastbight entrance. The hotel car park is located at basement level.





The Elizabeth Room

for up to 20 people

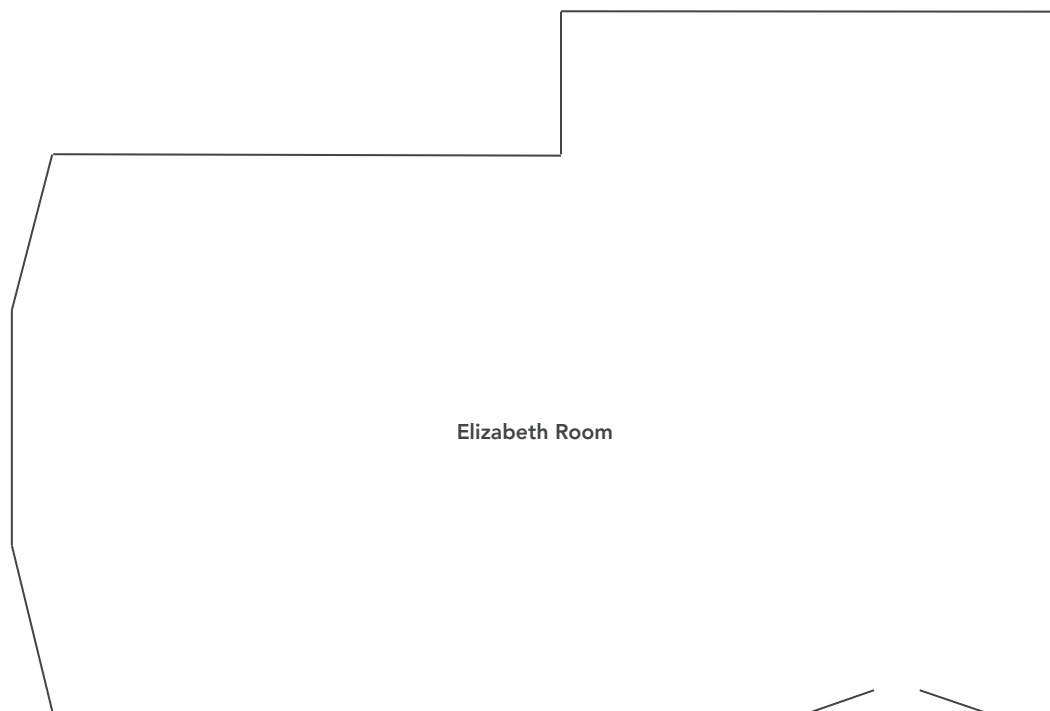

Elizabeth Room

ROOM LAYOUTS

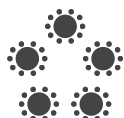

14



14

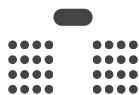

20



10



10



14

Located in the historic part of the hotel, The Elizabeth Suite is a cosy room, ideal for small meetings or dinners.

Guests can purchase drinks from our Lounge Bar which is located close by the room.

ROOM DIMENSIONS

5.6m x 5.1m

POWER SOCKETS

8

ACCESS

This room is located at ground level with main guest toilet facilities. Ground level is accessible via the lift from basement level, or alternatively with level access from our Eastbight entrance. The hotel car park is located at basement level.





The Priory Room

for up to 5 people

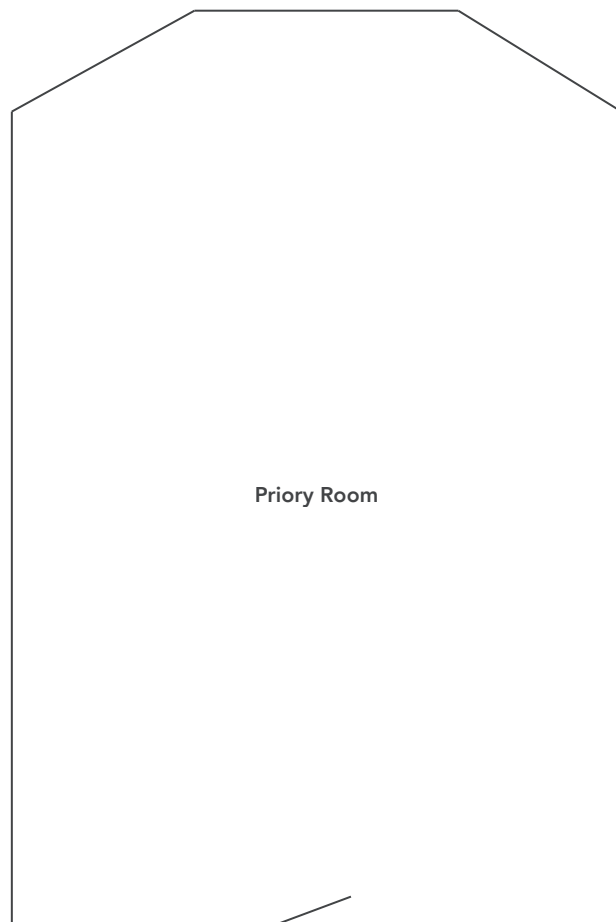

ROOM LAYOUTS

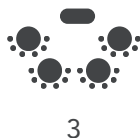
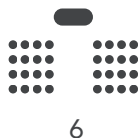
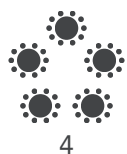

The Priory Room is perfect for interviews or one-to-one meetings where a small and quiet space is required.

Guests can purchase drinks from our Lounge Bar which is located close by the room.

ROOM DIMENSIONS

4.7m x 2.2m

POWER SOCKETS

6

ACCESS

This room is located at ground level with main guest toilet facilities. Ground level is accessible via the lift from basement level, or alternatively with level access from our Eastbight entrance. The hotel car park is located at basement level.





Delegate Packages

booking required for a minimum of 8 attendees

Standard Day Delegate - £42 per person

- 2 Servings of tea and coffee
- Finger buffet (Menu option 1)
- Equipment hire
- Room hire
- On-site parking
- Wi-Fi

Superior Day Delegate - £46 per person

- Unlimited tea and coffee
- Hot and cold buffet (Menu option 2 or 3)
- Equipment hire
- Room hire
- On-site parking
- Wi-Fi

24-Hour Day Delegate - £170 per person

- 2 Servings of tea and coffee
- Buffet lunch (Menu option 1)
- 2 Course evening meal
- Standard room accommodation for 1 person, with breakfast the following morning
- Equipment hire
- Room hire
- On-site parking
- Wi-Fi

AVAILABLE EQUIPMENT

- Projector and screen
- Flipchart and pens
- Paper and pens
- Speakers
- Microphone
- Lectern
- Laser pointer and clicker
- Extension leads

MENUS

- [Breakfast menu](#)
- [Dinner menu](#)
- [Buffet menus](#)

OPTIONAL EXTRAS

- Cake £2 per person
- Pastry £2 per person
- Breakfast roll £4 per person
- Scone and preserves £3 per person
- Canapes £5 per person

THINKING AHEAD TO CHRISTMAS?

Take a look at our Christmas Brochure for 2025 [here](#)

Contact our Sales Team on 01522 520348
or email sales@thelincolnhotel.com to enquire about your event

